

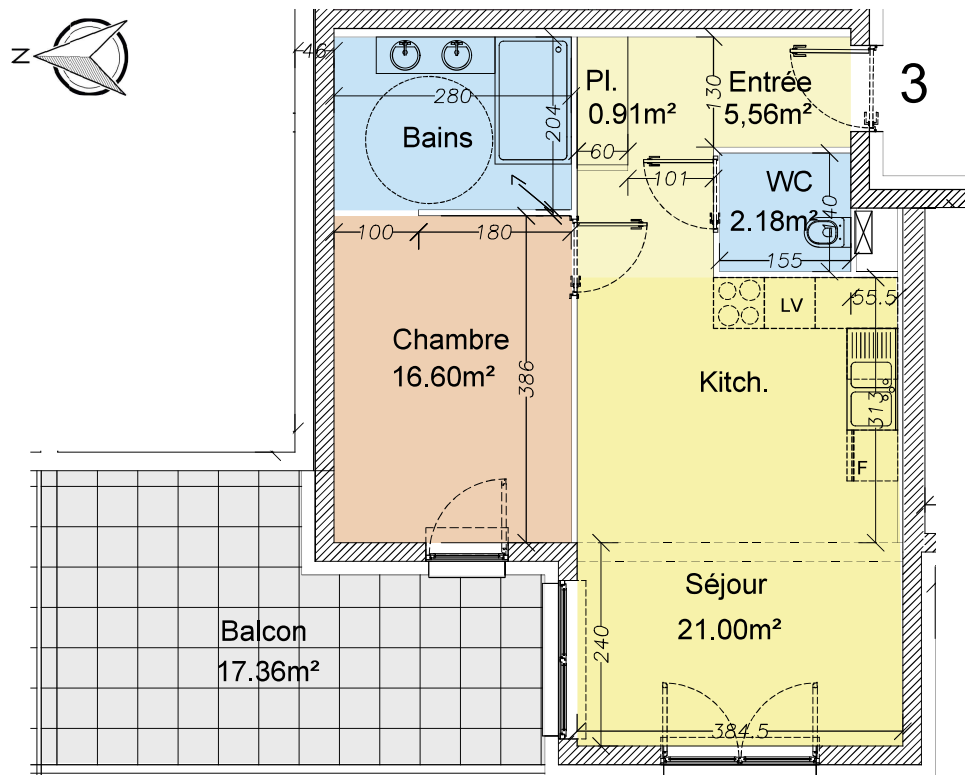

RESIDENCE
TOPAZE



Log. 3- T2 Niveau RDC

	m ²
ENTREE	5,56 m ²
EDP	0,91 m ²
WC	2,18 m ²
SEJOUR+ CUISINE	21,00 m ²
CHAMBRE + BAINS.	16,60 m ²
BALCON	17,36 m ²
SURFACE HABITABLE	46,25 m²