

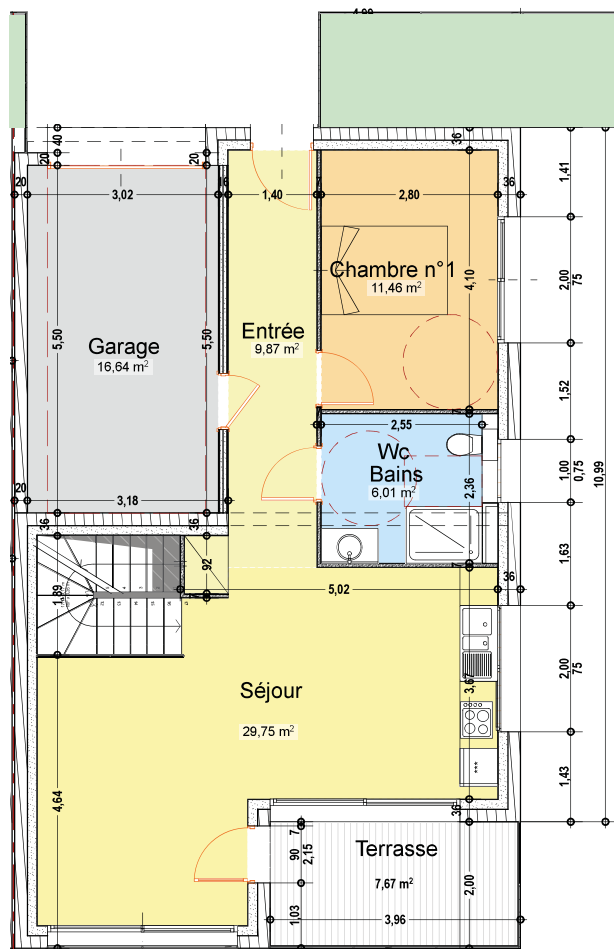

MAISONS SAPHIR



Maison 4- Niveau RDC

| | m ² |
|------------------------------|----------------------------|
| ENTREE | 9,87 m ² |
| BAINS | 6,01 m ² |
| SEJOUR+ CUISINE | 29,75 m ² |
| CHAMBRE | 11,46 m ² |
| GARAGE | 16,64 m ² |
| TERRASSE | 7,67 m ² |
| SURFACE HABITABLE RDC | 57,09 m² |



MAISONS SAPHIR

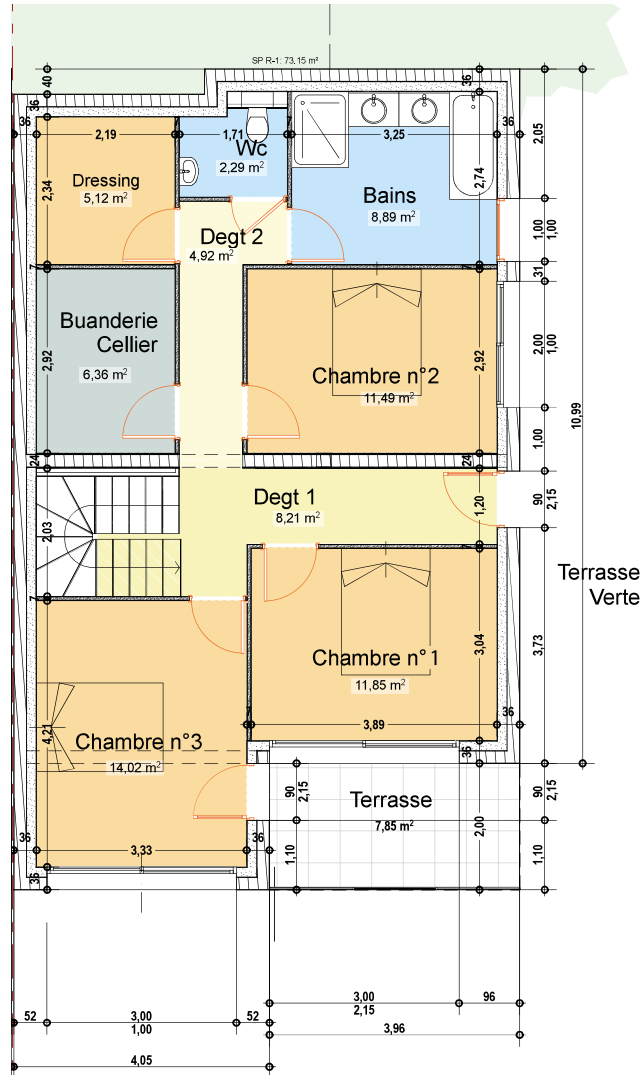

| Maison 4- Niveau R-1 | m ² |
|------------------------------|----------------------------|
| DEG. 1 | 8,21 m ² |
| BAINS | 8,89 m ² |
| WC | 2,29 m ² |
| DRESSING | 5,12 m ² |
| CELLIER | 6,36 m ² |
| DEG. 2 | 4,92 m ² |
| CHAMBRE 1 | 11,85 m ² |
| CHAMBRE 2 | 11,49 m ² |
| CHAMBRE 3 | 14,02 m ² |
| TERRASSE | 7,85 m ² |
| SURFACE HABITABLE R-1 | 73,15 m² |